

Public Safety Tappers, Low PIM 138-960 MHz, N-Female

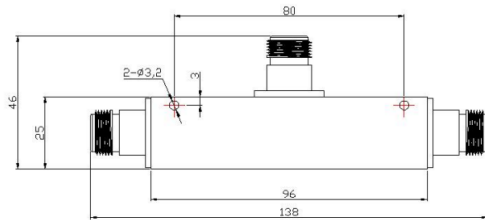

All dimensions are in mm

- ❖ Covers 138-960 MHz supporting Public Safety bands in VHF, UHF, 700/800, FirstNet and 850/GSM 900
- ❖ Low PIM (-153dBc) reliable design with minimal return loss and an excellent coupling flatness
- ❖ Suitable for indoor and outdoor applications (IP67)
- ❖ Compact size and light weight; Easy to install

For more information or to purchase, contact Ventev: 800.851.4965 or sales@ventev.com.

| Product Description | w/ N-type Female Connector | |
|----------------------|----------------------------|------------|
| | Ventev Part # | Tessco SKU |
| 3dB (2:1) Tapper | VEN-03TAP-196-NF | 608393 |
| 5dB (3:1) Tapper | VEN-05TAP-196-NF | 608395 |
| 6dB (4:1) Tapper | VEN-06TAP-196-NF | 608396 |
| 8dB (6:1) Tapper | VEN-08TAP-196-NF | 608390 |
| 10dB (10:1) Tapper | VEN-10TAP-196-NF | 605688 |
| 15dB (30:1) Tapper | VEN-15TAP-196-NF | 608391 |
| 20dB (100:1) Tapper | VEN-20TAP-196-NF | 608394 |
| 30dB (1000:1) Tapper | VEN-30TAP-196-NF | 608389 |

| Electrical Specifications | | | | | | | | |
|--|-----------------------------|------------------|------------------|------------------|------------------|------------------|------------------|------------------|
| Ventev Part # | VEN-03TAP-196-xF | VEN-05TAP-196-xF | VEN-06TAP-196-xF | VEN-08TAP-196-xF | VEN-10TAP-196-xF | VEN-15TAP-196-xF | VEN-20TAP-196-xF | VEN-30TAP-196-xF |
| Nominal Power Split Ratio (Outputs dB Delta) | 2:1 (3dB) | 3:1 (5dB) | 4:1 (6dB) | 6:1 (8dB) | 10:1 (10dB) | 30:1 (15dB) | 100:1 (20dB) | 1000:1 (30dB) |
| Output Split (dB) Main/Branch | -2.3/-4.8 | -1.8/-6.1 | -1.6/-7.0 | -0.7/-8.5 | -0.9/-10.4 | -0.5/-15.3 | 0.4/-20.1 | -0.3/-30.1 |
| Coupling Tolerance (dB) | 138-200 | -7.2 ±0.9 | -7.8 ±0.7 | -8.5 ±0.7 | -10.0 ±0.7 | -11.5 ±0.8 | -16.5 ±0.8 | -20.7 ±1.0 |
| | 200-250 | -6.5 ±0.7 | -6.8 ±0.6 | -8.0 ±0.6 | -9.5 ±0.6 | -10.7 ±0.7 | -15.6 ±0.8 | -20.1 ±1.0 |
| | 250-380 | -6.0 ±0.6 | -6.4 ±0.6 | -7.8 ±0.6 | -9.0 ±0.6 | -10.3 ±0.7 | -15.5 ±0.8 | -20.0 ±1.0 |
| | 380-520 | -5.5 ±0.6 | -6.1 ±0.6 | -7.5 ±0.6 | -8.5 ±0.6 | -10.1 ±0.7 | -15.2 ±0.8 | -20.1 ±1.0 |
| VSWR | 698-960 | -4.8 ±0.6 | -6.1 ±0.6 | -7.0 ±0.5 | -7.8 ±0.5 | -9.9 ±0.5 | -15.4 ±0.5 | -20.1 ±0.8 |
| | 138-380 | ≤1.4 | ≤1.4 | ≤1.3 | ≤1.3 | ≤1.25 | ≤1.25 | ≤1.25 |
| 380-960 | ≤1.35 | ≤1.35 | ≤1.35 | ≤1.35 | ≤1.25 | ≤1.25 | ≤1.25 | ≤1.25 |
| 3rd Order PIM (dBc) | ≤-153 dBc @2x43 dBm Carrier | | | | | | | |
| Power Rating (W) | 200W Average | | | | | | | |
| Impedance (Ω) | 50 Ω | | | | | | | |
| Connectors | N-Female | | | | | | | |

Public Safety Tappers, Low PIM 138-960 MHz, N-Female

| Mechanical Specifications | |
|-----------------------------|-------------------|
| Dimensions (w/o connectors) | 3.78 x 1.0 x 1.0" |
| Product Weight | 0.6 Lbs |
| Body and Color | Aluminum, Red |
| Mounting | Bracket Included |

| Environmental Specifications | |
|------------------------------|------------------|
| Operating Temperature | -35 °C to +65 °C |
| Operating Humidity | Up to 95% |
| Ingress Protection | IP65 |

Outline Drawing

